

FlexEdge™

Standard Long Jump Pit

INSTALLATION INSTRUCTIONS

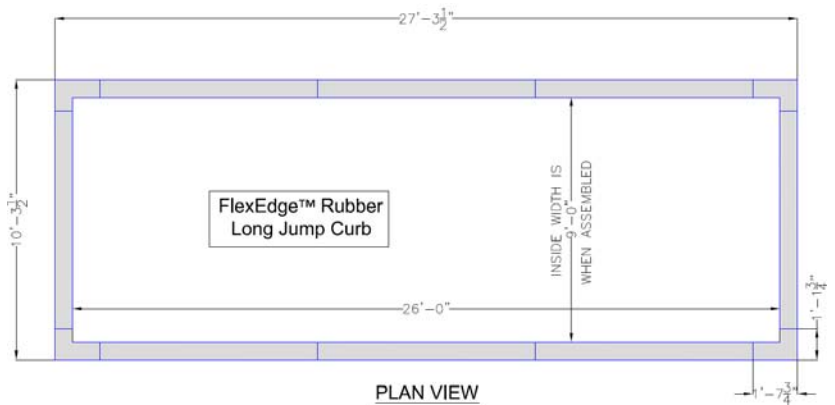

NOTE: ALWAYS BE AWARE OF THE FINISHED CURB HEIGHT REQUIREMENTS

Installation Option 1: Compacted Stone Base Installation (No Concrete)

1. Refer to drawings for overall layout and pit dimensions.
2. Sight and stake out the outside perimeter of the long jump pit layout. Grade the long jump pit curb location approximately 18" wide, then compact wet crusher dust/crushed stone, level this material to the correct height. Note: Take great care to compact the crushed stone base properly for a good installation.
3. Place a curb on top of compacted base; check the outer ledge (taller) of the rubber curb to be sure it is the desired finished height requirement. NOTE: you may have to add or remove some crushed stone dust to achieve the correct height. Compact again and continue.



Note: the photo below is of an L Curb installation and not a Long Jump Curb, for illustrative purposes only.

4. Once you have the correct height for the base, continue the leveling and compacting where the curb is to be placed. While the base work is being completed some of the crew can be placing the curbs out loosely around the perimeter. Be careful not to disturb the compacted base.
5. Start placing the LJ Pit curb at one corner of the pit to get the 90 degree angle set. Work out from this point.
6. Once a curb is correctly located, secure it to the subgrade/compacted base; this can be done by various methods, or a combination of them:

METHOD A – One (1) anchor per 8’ section:

- a) Using a ½” drill bit, drill a hole on a 45 degree angle at the end of the 8’ section (through the hole in the end of the curb) all the way through and out the bottom. With this method the anchor is being driven in on an angle through the hole on the end parallel to the rubber curb (See Figure 1A).

Figure 1A

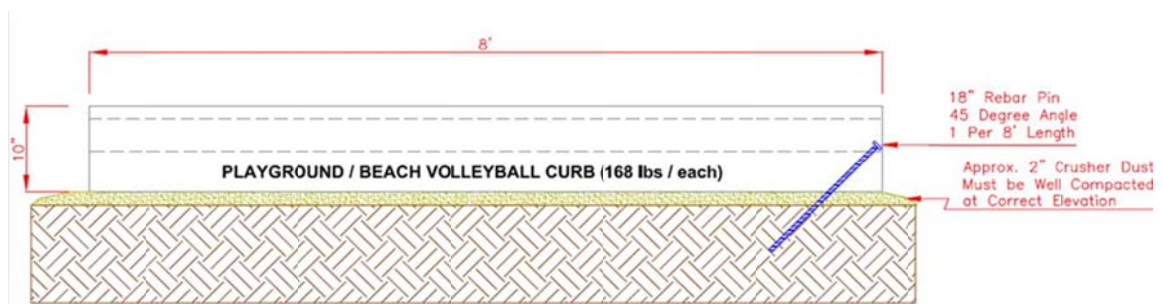

Figure 1B



- b) Using the ½” x 18” Long rebar pin (supplied by SportsEdge), drive the rebar into the pre-drilled hole (See Figures 1B & 1C) on a 45 degree angle into the compacted base, the pin must be completely inside so it does not obstruct the gluing together of the next rubber section.

Figure 1C



BETASEAL ADHESIVE PREP

The Betaseal adhesive is thick and can be a little difficult to pump out with the caulking gun in cold weather. If available, use a tube heater that warms 6 tubes at a time. If one is not available at your site, please find some way to warm the product. The warmer it is the easier it spreads.



7. Place about 5 passes ¼” bead of the Betaseal adhesive on the end of the already anchored curb.



8. Have at least two people pick up the next curb and carefully place it tightly against the anchored curb. Note: do not drag the curb over the compacted base, this may cause a push up of the base material and this will cause a hump in the curb. Smooth any Betaseal that oozes from the joints when being squeezed together. Apply an additional bead of Betaseal at the seam on the exterior, and then smooth out with a putty knife or trowel.



9. Before placing the anchors into the next hole, be sure the curb is level and even with the previously installed curb. Periodically, during installation have your surveyor sight check the curb height, to make sure that everything is staying at the required elevation.

10. Once the curb is pushed tightly against the previously anchored curb and sealed, drive in the next anchor the same way as the previous.

Very Important: Use caution not to hit the curb, only the pin, use a large punch or another piece of rebar to drive the rebar pin inside of the rubber curb.

11. With a putty knife or trowel screed off any excess adhesive that may have pushed out from the joint. Have a plastic container and rag with you to wipe away any build up on the trowel. Once the curbs have been installed or during installation, periodically go back over the joints, before the adhesive totally cures and see if any of them need additional adhesive or have an excess. You want the seam to be as unnoticeable as possible.

PLEASE NOTE: SportsEdge recommends using additional rebar pins on the side of the rubber curbs (See Figure 2A) to help prevent movement and misalignment of the curbs during construction or when backfilling up to the curbs. If the installing contractor chooses not to use additional rebar bins, great care must be taken during construction and backfill to maintain proper alignment of the rubber curbs.

METHOD B – 2 Additional 45° Anchors per 8' Section:

- In addition to the single rebar pin through the hole on the end, predrill and drive 2 additional 18" rebar pins (supplied by SportsEdge), through the side of the rubber curb downward on a 45 degree angle. These holes should be located approximately 30" from each end of an 8' curb. The pins are to aid in keeping the curb in position during installation and backfill.
- Before placing the anchor into the hole, be sure the curb is level and straight with the string line. Always follow the sight string line carefully, so the side of the curb is straight, not wavy.
- **Helpful Hint:** If one person places his foot (out of harm's way) on the curb, while the anchor is being installed, this will help prevent the curb from moving and displacing the base.

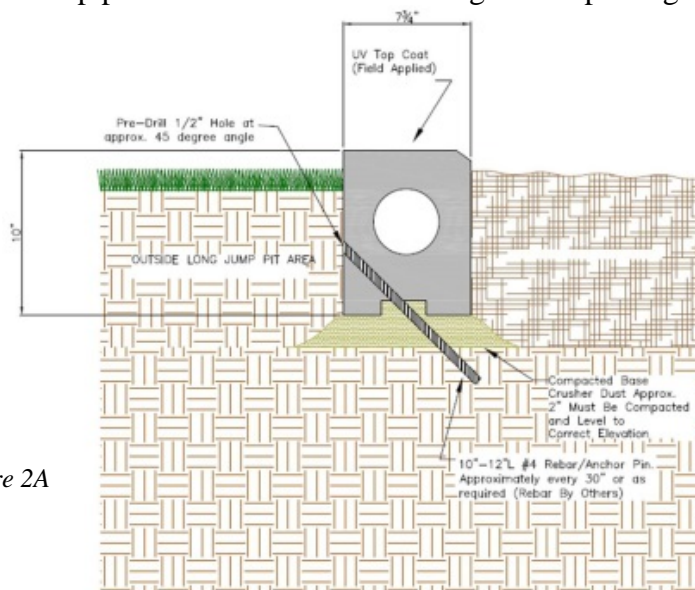

Figure 2A

METHOD C - 3 Vertical Anchor Pins per 8' section:

PLEASE NOTE: For this Installation method the SportsEdge anchor pins with the welded top cap will not work because of the requirement to recess the rebar 1" into the rubber curb. The contractor must supply their own 18" - 24" pieces of straight rebar for this installation method. This installation method would eliminate the need for the anchor pin at a 45 degree angle at the end as described in Methods A & B.

- Using a 1/2" x 12" long drill bit, drill vertical holes (3 per 8' section) through the curb from the top all the way through and out the bottom. One hole should be drilled in the middle of each 8' length, and the other two holes should be located approximately 12"-18" in from each end.
- Before placing the anchors into the holes, be sure the curb is level and straight with the string line.
- Drive the rebar pins (**NOT supplied by SportsEdge**) through the curb and into the ground.
(See Figure 3A & 3B)
- Very important: **drive the rebar pin into the rubber curb so it is recessed approximately 1" down inside the rubber curb**; this recess will be filled later with the black BetaSeal adhesive/sealant.
(See Figure 3b)
- Always follow the sight string line carefully, so the side of the curb is straight, not wavy.

Helpful Hint: The pins are to aid in keeping the curb in position during installation and backfill. If one person places his foot (out of harm's way) on the curb, while the anchor is being installed, this will help prevent the curb from moving and displacing the base. In sandier soils longer rebar anchors may be necessary.

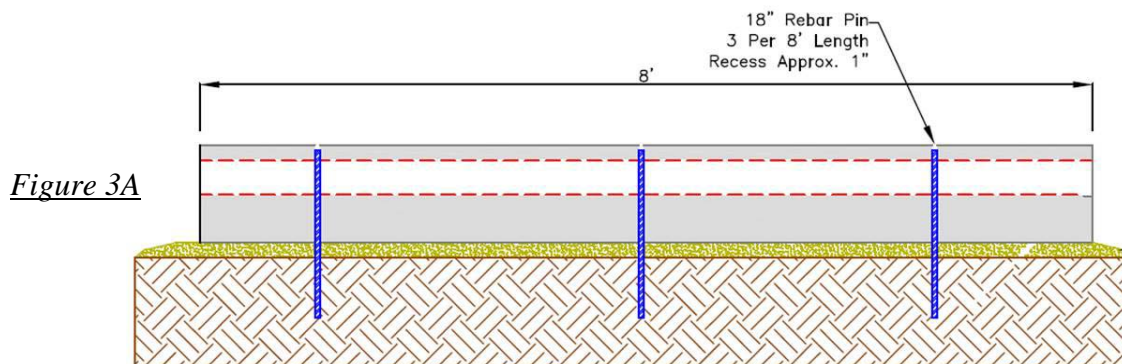
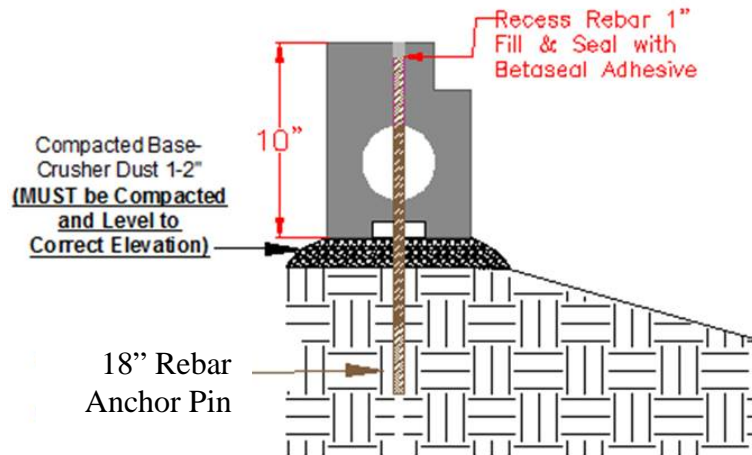

Figure 3B



12. After all the curbs are properly installed and in place:

- Using the (2 Part) Top Coat Urethane, paint all top areas of the curb that will be exposed to sunlight in the finished installation. It is not necessary to coat areas that will not be exposed to sunlight.
- Two coats are required. The material will go much further in the second application.



*2 Part
UV Top Coat*