

HEAVY DUTY 18" x 60" x 2" x 11 GA. STEEL PERFORATED METAL PANEL

FEATURES:

- > MAIN POLE: 2 PIECE 5" SCH40, 5 9/16" OD STEEL PIPE
- > HEAVY DUTY 18" x 60" x 2" x 11 GA. STEEL PERFORATED METAL PANEL
- > TOUGH POWDER COATED YELLOW FINISH OVER ZINC RICH PRIMER
- > PERMANENT OR SEMI-PERMANENT INSTALLATION
- > FOUL POLE DESIGNED TO WITHSTAND UP TO 150 MPH WIND
- > TYPICAL FOOTING SHOWN (BASED ON 100 MPH WIND)

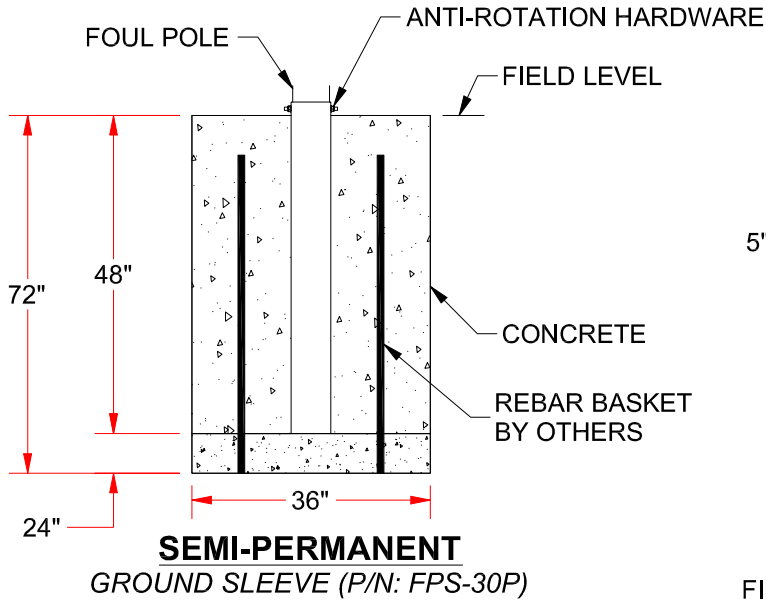
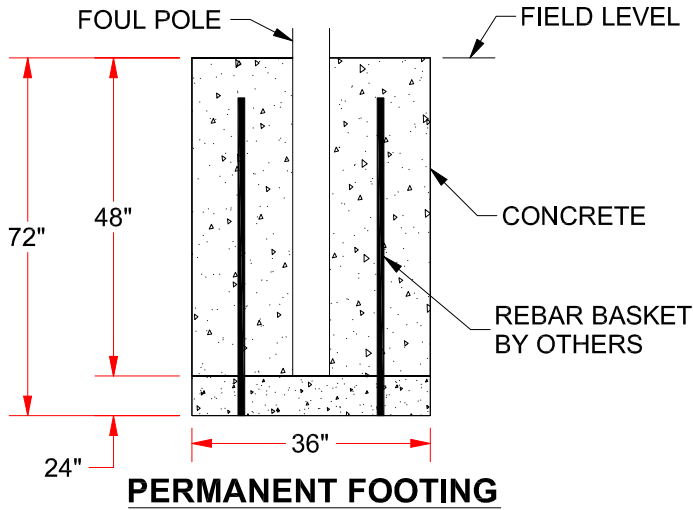

NOTE: THESE ARE SUGGESTED DIMENSIONS FOR AVERAGE SOIL CONDITIONS, CONSULT LOCAL BUILDING CODES.

