

**PART # SEFLEXLJ3A**  
(SECTION "A" - QTY. X6)

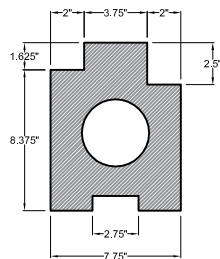

**PART # SEFLEXLJ3B**  
(SECTION "B" - QTY. X6)

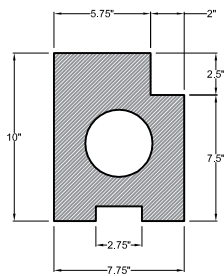

**PART # SEFLEXLJ2**  
(SECTION "C" - QTY. X2)

## FlexEdge™ Rubber Long Jump Pit Curb System w/ Side Sand Catchers, 26" (Aluminum Sand Pit Cover Sold Separately)

### INCLUDED WITH KIT:

- (2) - PRE-FABRICATED RIGHT CORNERS (PART # SEFLEXLJ3RC)
- (2) - PRE-FABRICATED LEFT CORNERS (PART # SEFLEXLJ3LC)
- (6) - CURB SECTION "A", 1  $\frac{5}{8}$ " LEDGE (PART # SEFLEXLJ3A)
- (6) - CURB SECTION "B", 1  $\frac{5}{8}$ " LEDGE / 2  $\frac{1}{2}$ " LEDGE (PART # SEFLEXLJ3B)
- (2) - CURB SECTION "C", 2  $\frac{1}{2}$ " LEDGE (PART # SEFLEXLJ2)
- (16) - FIBERGLASS SAND CATCHER GRATE, 1M EACH (PART # SESCOFG)
- (16) - FLEXEDGE SAND CATCHER MAT, 1M EACH (PART # SEFLEXSCM)
- (18) - 18" REBAR ANCHORS (PART # SEFLEXA18)
- (10) - ADHESIVE TUBES (PART # SELEXBST)
- (3) - UV TOP COAT (PART # SEFLEXTC)

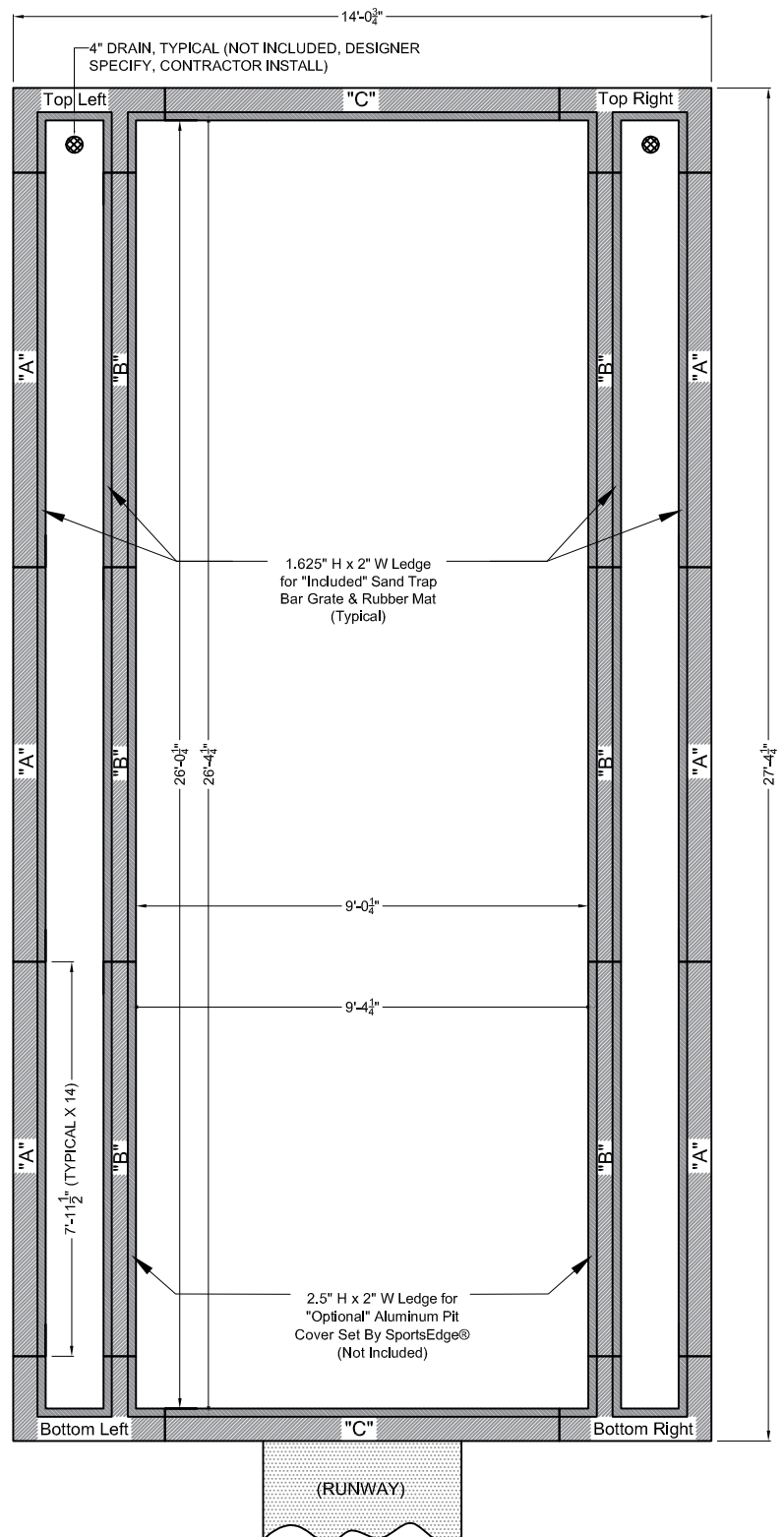

## TITLE: SportsEdge® FlexEdge Long Jump / Triple Jump Pit w/ Side Catchers & Cover Ledge - 26"

DRAWN BY: B.W.M.

CHECKED BY: N/A

DRAWING NUMBER:

SCALE: NONE

DATE: 03.07.22

A-

SEFLEXLJ3K26

**DISCLAIMER:** The customer and the customer's architects, engineers, consultants and other professionals are completely responsible for the selection, installation, and maintenance of any product purchased from ABT, and EXCEPT AS EXPRESSLY PROVIDED IN ABT'S STANDARD WARRANTIES, ABT MAKES NO WARRANTY, EXPRESS OR IMPLIED, AS TO THE SUITABILITY, DESIGN, MERCHANTABILITY, OR FITNESS OF THE PRODUCT FOR CUSTOMER'S APPLICATION. Copies of ABT's standard warranties are available upon request.

Proprietary right of ABT, Inc. are included in the information disclosed herein. The recipient, by accepting this document, agrees that neither this document nor the information disclosed herein nor any part thereof shall be copied, reproduced or transferred to others for manufacturing or for any other purpose except as specifically authorized in writing by ABT, Inc..

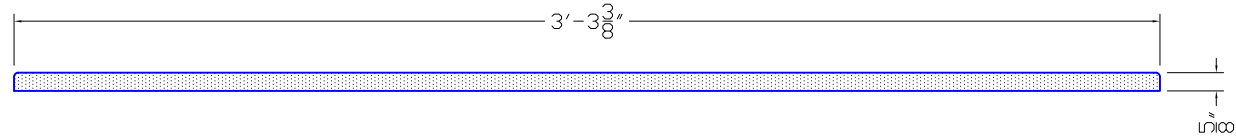

SportsEdge® FlexEdge® Sand Catcher Rubber Mat (Side View)

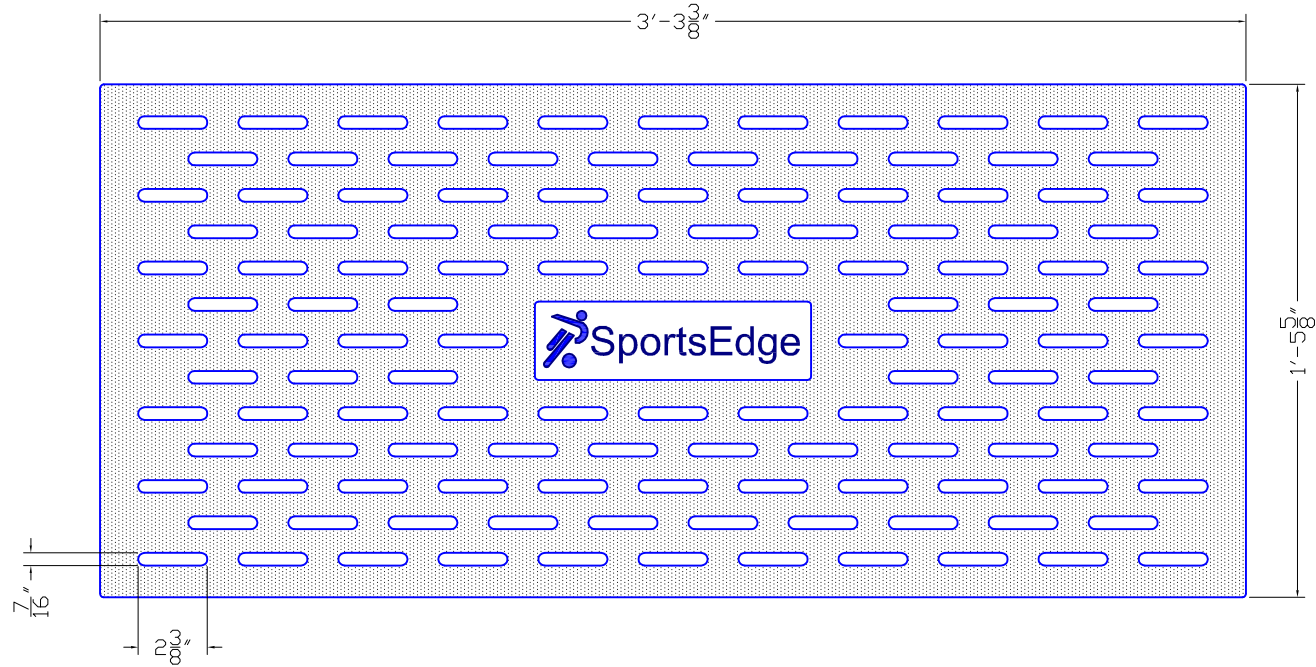

SportsEdge® FlexEdge® Sand Catcher Rubber Mat (Top View)

Specifications:

- Designed to be incorporated over a Fiberglass Sand Catcher Grate base unit.
- Consist of (1) molded mat, 1'-5 <sup>5</sup>/<sub>8</sub>" W x 3'-3 <sup>3</sup>/<sub>8</sub>" L x <sup>5</sup>/<sub>8</sub>" T, composed of 100% recycled rubber.
- Matte black finish; requires field application of UV Top Coat (same coating field applied to all FlexEdge® products).
- Unit Weight = Approx. 14.075 lbs.

 <p>A Division of ABT, Inc. P.O. Box 837 / 259 Murdock Road Troutman, NC 28166 (800) 334-6057</p>	<b>TITLE:</b> SportsEdge® FlexEdge LJ/TJ Sand Catcher Mat		
	<b>DRAWN BY:</b> B.W.M.	<b>CHECKED BY:</b> XXX	<b>DRAWING NUMBER:</b>
	<b>SCALE:</b> NONE	<b>DATE:</b> 04.08.20	<b>A- SEFLEXSCM</b>
<small><b>DISCLAIMER:</b> The customer and the customer's architects, engineers, consultants and other professionals are completely responsible for the selection, installation, and maintenance of any product purchased from ABT, and EXCEPT AS EXPRESSLY PROVIDED IN ABT'S STANDARD WARRANTIES, ABT MAKES NO WARRANTY, EXPRESS OR IMPLIED, AS TO THE SUITABILITY, DESIGN, MERCHANTABILITY, OR FITNESS OF THE PRODUCT FOR CUSTOMER'S APPLICATION. Copies of ABT's standard warranties are available upon request.</small>			
<small>Proprietary right of ABT, Inc. are included in the information disclosed herein. The recipient, by accepting this document, agrees that neither this document nor the information disclosed herein nor any part thereof shall be copied, reproduced or transferred to others for manufacturing or for any other purpose except as specifically authorized in writing by ABT, Inc..</small>			

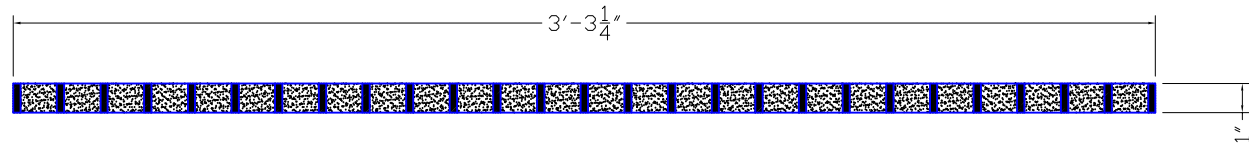

SportsEdge® FlexEdge® Sand Catcher Fiberglass Grate (Side View)

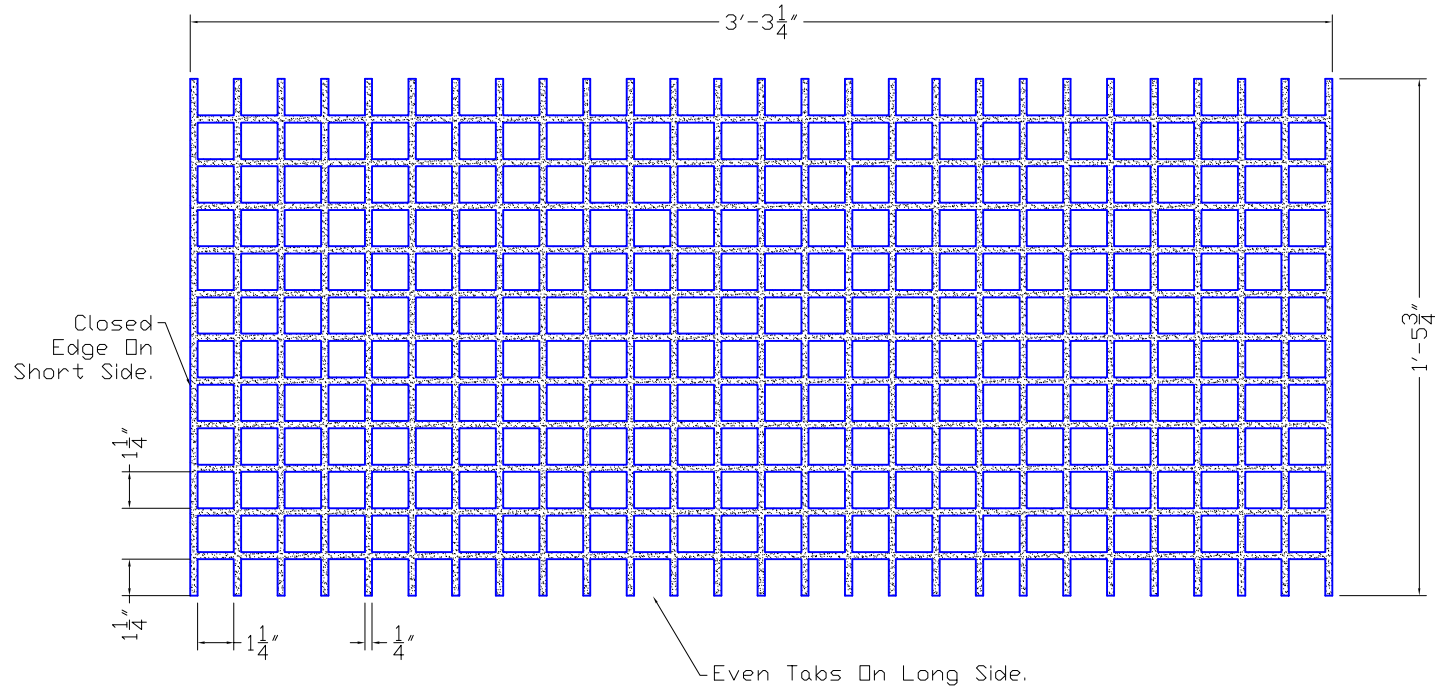

SportsEdge® FlexEdge® Sand Catcher Fiberglass Grate (Top View)

Specifications:

- Designed to be incorporated under a FlexEdge Sand Catcher Rubber Mat unit.
- Consist of (1) Dark Gray Molded Fiberglass Grate (IFR Polyester Resin), 17-3/4" W x 39-1/4"L x 1"T, with a "Grit" surface finish.
- Includes a 1-1/4" grid pattern with closed banding on the short ends and open banding on the long sides.
- Rib Thickness =  $\frac{1}{4}$ "
- Product is UV Resistant / 70% Open Area.
- Unit Weight = Approx. 12.579 lbs.

 <p>A Division of ABT, Inc. P.O. Box 837 / 259 Murdock Road Troutman, NC 28166 (800) 334-6057</p>	<b>TITLE: SportsEdge® FlexEdge LJ/TJ Sand Catcher Grate</b>		
	<b>DRAWN BY:</b> B.W.M.	<b>CHECKED BY:</b> XXX	<b>DRAWING NUMBER:</b>
	<b>SCALE:</b> NONE	<b>DATE:</b> 04.08.20	<b>A- SESCFCG</b>
<small><b>DISCLAIMER:</b> The customer and the customer's architects, engineers, consultants and other professionals are completely responsible for the selection, installation, and maintenance of any product purchased from ABT, and EXCEPT AS EXPRESSLY PROVIDED IN ABT'S STANDARD WARRANTIES, ABT MAKES NO WARRANTY, EXPRESS OR IMPLIED, AS TO THE SUITABILITY, DESIGN, MERCHANTABILITY, OR FITNESS OF THE PRODUCT FOR CUSTOMER'S APPLICATION. Copies of ABT's standard warranties are available upon request.</small>			
<small>Proprietary right of ABT, Inc. are included in the information disclosed herein. The recipient, by accepting this document, agrees that neither this document nor the information disclosed herein nor any part thereof shall be copied, reproduced or transferred to others for manufacturing or for any other purpose except as specifically authorized in writing by ABT, Inc..</small>			

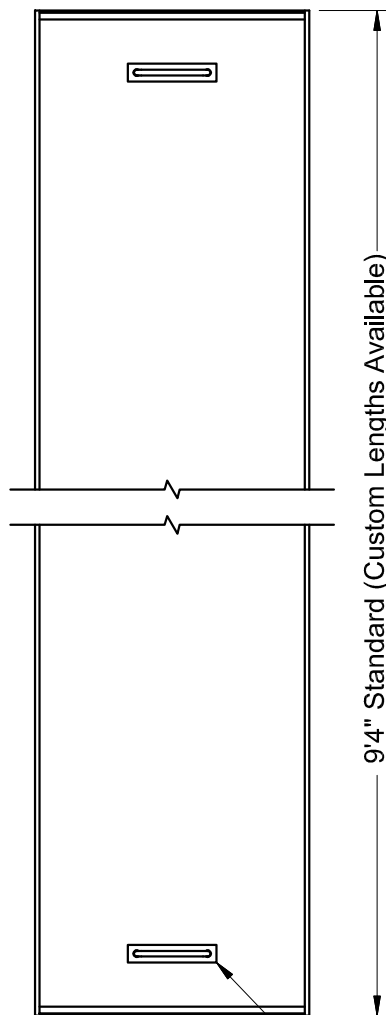

TOP VIEW

Wooden Spacer, to be Removed After Track Surfacing is Applied

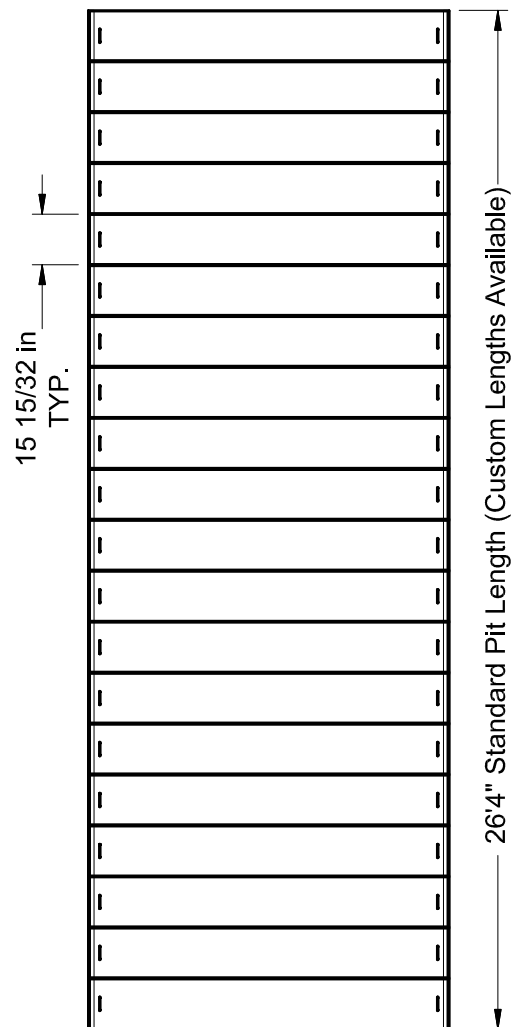

9'4" Standard Ledge Width (Custom Widths Available)

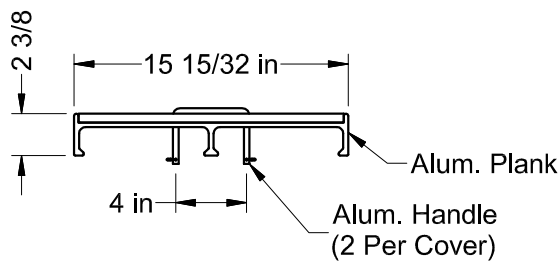

END VIEW

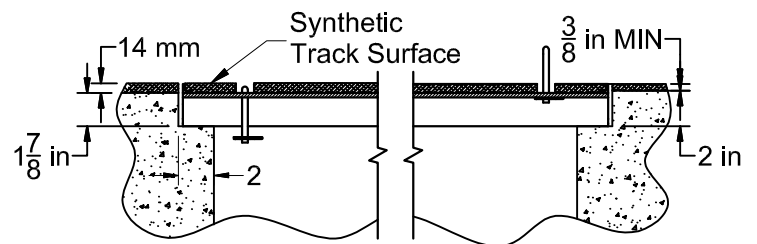

Covers have 0.5" recess for synthetic track surfacing. Ledge depth is to be determined by the contractor based on the track surface selection.



A Division of ABT, Inc.  
P.O. Box 837 / 259 Murdock Road  
Troutman, NC 28166  
(800) 334-6057

PRODUCT DETAIL © 2019 ABT, Inc.  
**LONG AND TRIPLE JUMP  
SAND PIT COVER**

PART:

**SEPCRLX02**

REV:  
2/27/2019

Proprietary rights of ABT, Inc. are included in the information disclosed herein. The recipient, by accepting this document, agrees that neither this document nor the information disclosed herein nor any part thereof shall be copied, reproduced or transferred to others for manufacturing or for any other purpose except as specifically authorized in writing by ABT, Inc.

**DISCLAIMER:** The customer and the customer's architects, engineers, consultants and other professionals are completely responsible for the selection, installation, and maintenance of any product purchased from ABT, and EXCEPT AS EXPRESSLY PROVIDED IN ABT'S STANDARD WARRANTIES, ABT MAKES NO WARRANTY, EXPRESS OR IMPLIED, AS TO THE SUITABILITY, DESIGN, MERCHANTABILITY, OR FITNESS OF THE PRODUCT FOR THE CUSTOMER'S APPLICATION. Copies of ABT's standard warranties are available upon request.



A Division of ABT, Inc.  
P.O. Box 837 / 259 Murdock Road  
Troutman, NC 28166  
(800) 334-6057

## DIMENSIONAL CERTIFICATION FORM SEPC.RL LONG AND TRIPLE JUMP SAND PIT

### Instructions:

Record as-built / verified dimensional information of the long and triple jump sand pit on this form pertaining to the cover order.

Measurements should be to the nearest  $\frac{1}{16}$ " [1 mm].

Dimensions 4 through 12 should be measured from outside of ledge to outside of ledge and equally spaced along the length of the pit.

Please complete this form in its entirety.

Note: Covers will be built  $\frac{1}{2}$ " shorter than the smallest width provided unless otherwise specified.

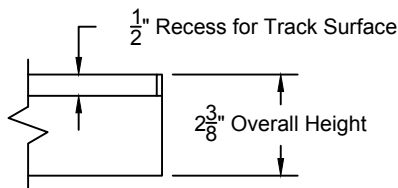

### COVER DETAIL

☐ Please check box to confirm  $2\frac{3}{8}$ " cover height

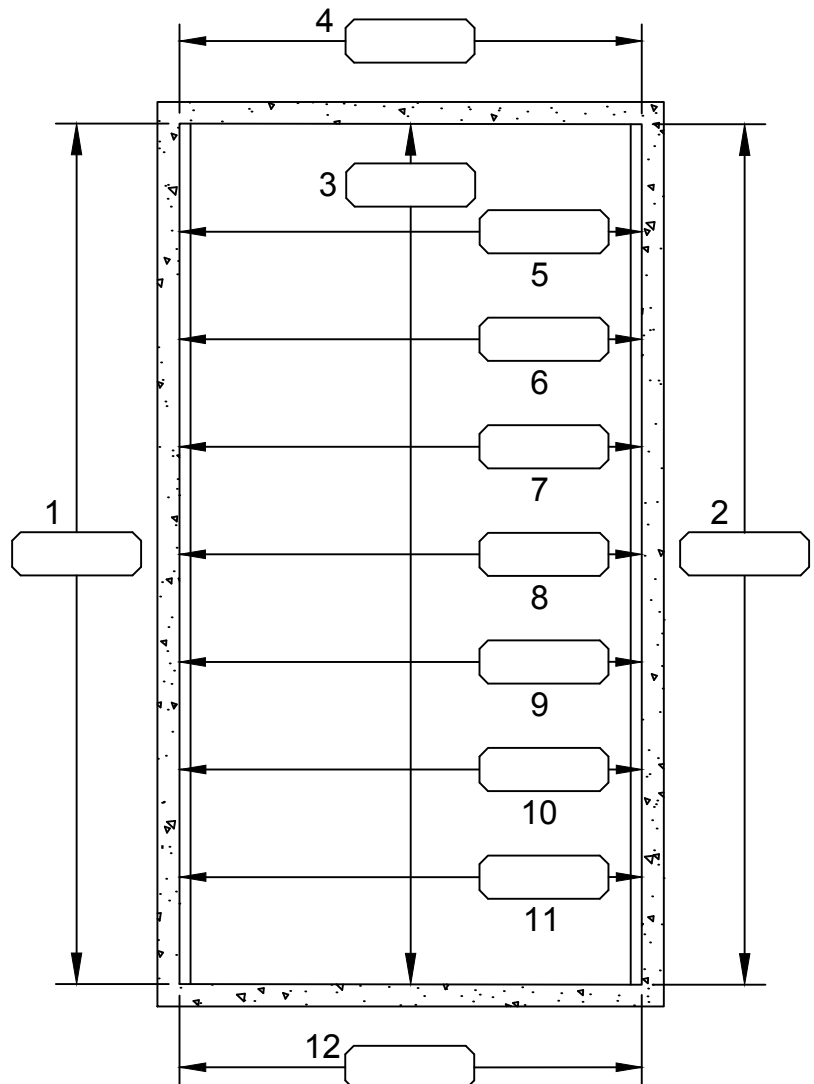

### TOP VIEW

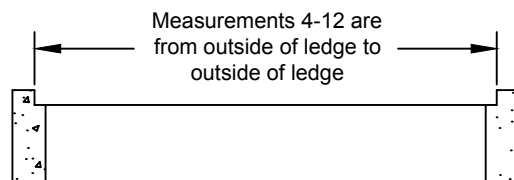

### ELEVATION VIEW

#### Contact Information:

Name: \_\_\_\_\_

Address: \_\_\_\_\_

Phone: \_\_\_\_\_

Fax: \_\_\_\_\_

#### Project Information:

Project Title: \_\_\_\_\_

Location: \_\_\_\_\_

#### Certification:

Name & Title of Authorizing Official: \_\_\_\_\_

Signature: \_\_\_\_\_ Date: \_\_\_\_\_